

Category	Installed / Type	Legislation Used
Main Legislation Used	N/A	Fire Scotland Act PT3 2006 Building Scotland Regulations 2004 and Scottish Building Standards Technical handbook, Non Domestic
Fire Extinguishers	Installed	Layout within stores as per Tesco design standard. To comply with requirements of BS 5306 Pts 1 & 3 / BS EN3 part 5
Fire blankets	N/A	Layout within stores as per Tesco design standard. To comply with requirements of BS 5306 Pt 8
Smoke / heat detectors	Installed	Location as per requirements of building Scotland regulations 2004 and Scottish Building Standards Technical handbook, Non Domestic Fire alarms to be installed by / maintained by BAFFE and Tesco approved contractors conform to BS 5839 Fire alarms links to fire doors in compartment walls to comply with BS5839 Pts
Down stands / curtains	Fixed	Requirements of Building Scotland Regulations 2004 and Scottish Building Standards Technical handbook, Non Domestic Construction depends on size of store / store layout. Solid construction either glass or boarding Drop curtains made up of flexible fire rated material to suit.
Sprinkler systems	Installed	Installed under the requirements of Building Scotland Regulations and Scottish Building Standards Technical Handbook, Non Domestic Installation also to comply with BS 5306 Pt 2 and Tesco Design Standards.
Maglocks	N/A	Not legal in areas where members of the public can use doors as a means of escape in the event of fire.
Sliding doors	N/A	If doors on a means of escape route are of a slide to open nature then they have to comply with BS7036:1999
Emergency lighting	N/A	As per tesco design standards and to comply with requirements of building Scotland regulations 2004 and Scottish building standards technical handbook, Non domestic. Installation to conform to BS5266 Pt 2004 and BS5266 Pt 8 2004
Compartment walls	N/A	Constructed to meet with the requirements of building Scotland regulations 2004 and Scottish building standards technical handbook, Non domestic. Construction dependent on the age of store, min 1hr max 2hrs.
Evac chairs	N/A	Requirements of building Scotland regulations 2004 and Scottish building standards technical handbook, Non domestic store with TFF 1 number chair located in each stair enclosure leading from upper level where public have access. BS 5688 P8
Direction signage	N/A	Located under the requirements of building Scotland regulations 2004 and Scottish building standards technical handbook, Non domestic Fire Scotland Act Pt 3 2006 Fire precautions (workplace) Reg 5/32 s 1997
Break glass units	N/A	Locations at every door that can be used to egress the building. Requirements of building Scotland regulations 2004 and Scottish building standards technical handbook, Non domestic. Fire Scotland Act Pt 3 2006

REV	DATE	AMENDMENTS
2#		TOTAL LICENCED FRONTAGE : 29.368 SQM

MAIN STREET



TESCO EXPRESS
99 MAIN STREET
ADDRESS: PRESTWICK
SOUTH AYRSHIRE
KA9 1JS
SCOTLAND

Disclaimer: Any information contained in this drawing which is not required by regulation 6 of SSI 2007/452 is included for illustrative purposes only and does not form part of the layout plan for the purposes of the said regulation or the Licensing (Scotland) Act 2005. This will prevent us requiring a new application when other areas of the store change.

CHILDREN AND YOUNG PERSONS ARE ALLOWED ACCESS THROUGHOUT THE PREMISES

FIRE DETECTION LEGEND

- SOUNDER
- VISUAL INDICATOR (BEACON)
- 6KG 27A FOAM & 2KG CO2 EXTINGUISHERS
- AREA COVERED BY SMOKE DETECTION
- BREAK GLASS CALL POINT

AREA TO BE USED FOR THE DISPLAY OF ALCOHOL; PRODUCTS PACKED WITH ALCOHOL AND NON-ALCOHOL DRINKS

PROJECT :
5419
MAIN STREET PRESTWICK EXP

DESCRIPTION
PROPOSED ALCOHOL LICENCE SITE LAYOUT

DRAWING NO. 5419pg2#BWSPLAN.dwg

PHASE **3** ISSUE **2#**

SYSTEM ID. No. 5419bg2#BWSPLAN.dwg

SCALE 1:100@A3 DATE 17.12.2018

UK PLANNING MANAGER **STEVEN ANDRZEJUK**



TESCO STORES LIMITED
EXPRESS GROUP
HIGHWOOD BUILDING, KESTREL WAY, HERTFORDSHIRE
WELWYN GARDEN CITY, HERTFORDSHIRE, ALY 1GB UK
TELEPHONE: 01707 395150

THE COMPANY'S TRADE MARK IS THE RED TESCO LOGO. THE TESCO LOGO IS A TRADE MARK OF THE COMPANY AND IS NOT TO BE REPRODUCED OR TRANSMITTED IN ANY FORM OR BY ANY MEANS, ELECTRONIC OR MECHANICAL, INCLUDING PHOTOCOPYING, RECORDING, OR BY ANY INFORMATION STORAGE AND RETRIEVAL SYSTEM, WITHOUT THE WRITTEN PERMISSION OF THE COMPANY.

Category	Installed / Type	Legislation Used
Main Legislation Used	N/A	Fire Scotland Act Pt 3 2006 Building Scotland Regulations 2004 and Scottish Building Standards Technical handbook, Non Domestic
Fire Extinguishers	Installed	Layout within stores as per Tesco design standard. To comply with requirements of BS 5306 Pts 1 & 3 / BS EN3 part 5
Fire blankets	N/A	Layout within stores as per Tesco design standard. To comply with requirements of BS 5306 Pt 8
Smoke / heat detectors	Installed	Location as per requirements of building Scotland regulations 2004 and Scottish Building Standards Technical Handbook, Non Domestic Fire alarms to be installed by / maintained by BAFFE and Tesco approved contractors to conform to BS 5839 Fire alarms links to fire doors as in compartment walls to comply with BS5309 Pts
Down stands / curtains	Fixed	Requirements of Building Scotland Regulations 2004 and Scottish Building Standards Technical handbook, Non Domestic Construction method as per of store / above service / solid construction either glass or boarding Drop curtains made up of fire rated material to suit.
Sprinkler systems	Installed	Installed under the requirements of Building Scotland Regulations and Scottish Building Standards Technical Handbook, Non Domestic Installation area to comply with BS 5306 Pt 2 and Tesco Design Standards
Maglocks	N/A	Not legal in areas where members of the public can use doors as a means of escape in the event of fire.
Sliding doors	N/A	If doors on a means of escape route are of a slide to open nature then they have to comply with BS7036 1999
Emergency lighting	N/A	As per tesco design standards and to comply with requirements of building Scotland regulations 2004 and Scottish building standards technical handbook, Non Domestic Installation area to comply with BS 5306 Pt 2 and Tesco Design Standards
Compartment walls	N/A	Constructed to meet with the requirements of building Scotland regulations 2004 and Scottish building standards technical handbook, Non Domestic Construction dependent on the age of store, min 1 hr max 2hrs.
Evac chairs	N/A	Requirements of building Scotland regulations 2004 and Scottish building standards technical handbook, Non domestic store with TFF 1 number chair located in each stair enclosure leading from upper level where public have access. BS 5588 P8
Direction signage	N/A	Located under the requirements of building Scotland regulations 2004 and Scottish building standards technical handbook, Non domestic fire Scotland Act Pt 3 2006 Fire precautions (workplace) Reg 5/32 s 1997
Break glass units	N/A	Locations at every door that can be used to egress the building. Requirements of building Scotland regulations 2004 and Scottish building standards technical handbook, Non domestic. Fire Scotland Act Pt 3 2006

REV	DATE	AMENDMENTS
2#		TOTAL LICENCED FRONTAGE : 29.368 SQM

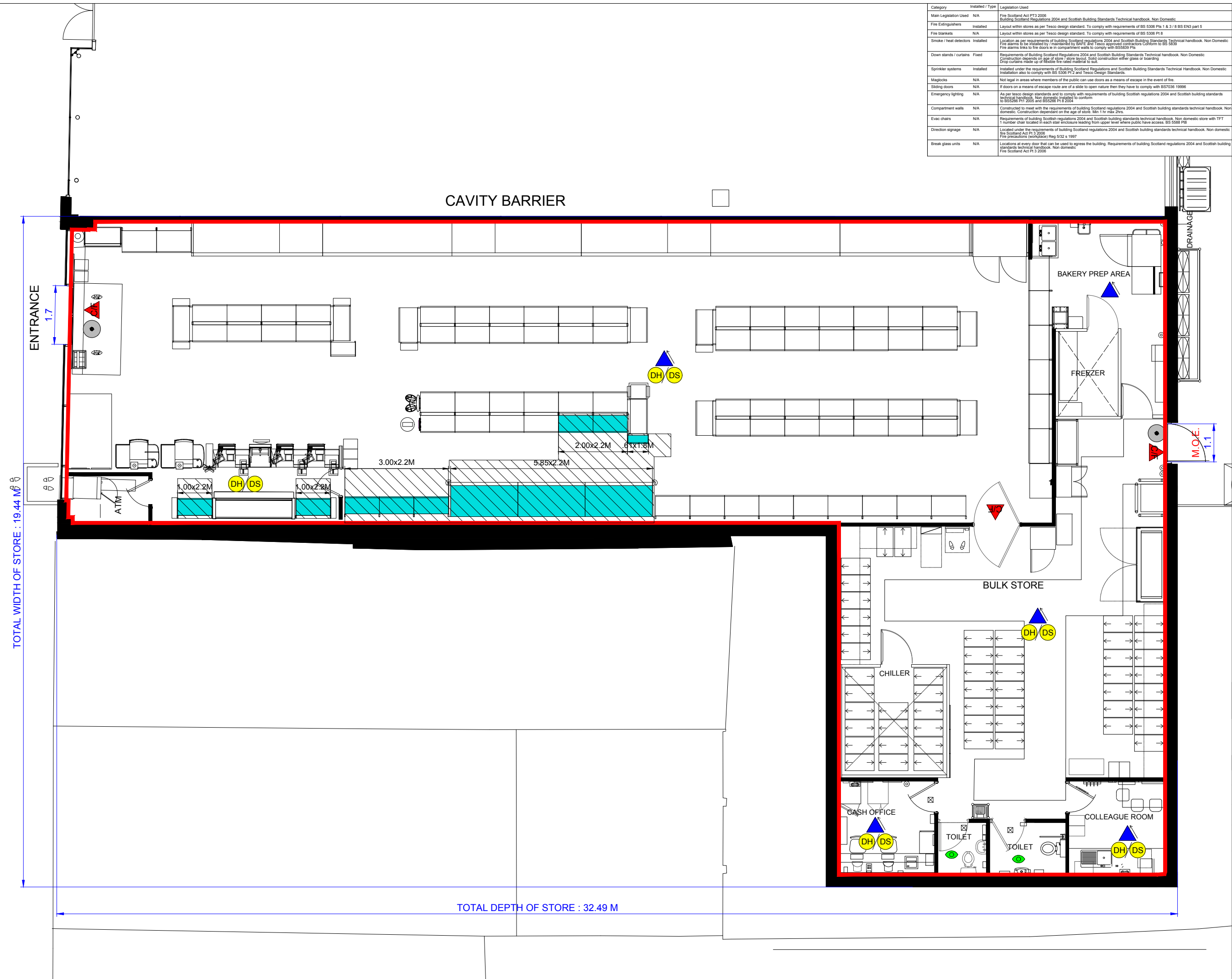

TESCO EXPRESS
99 MAIN STREET
ADDRESS: PRESTWICK
SOUTH AYRSHIRE
KA9 1JS
SCOTLAND

Disclaimer: Any information contained in this drawing which is not required by regulation 6 of SSI 2007/452 is included for illustrative purposes only and does not form part of the layout plan for the purposes of the said regulation or the Licensing (Scotland) Act 2005. This will prevent us requiring a new application when other areas of the store change.

- CHILDREN AND YOUNG PERSONS ARE ALLOWED ACCESS THROUGHOUT THE PREMISES
- FIRE DETECTION LEGEND**
- SOUNDER
 - VISUAL INDICATOR (BEACON)
 - 6KG 27A FOAM & 2KG CO2 EXTINGUISHERS
 - AREA COVERED BY SMOKE DETECTION
 - BREAK GLASS CALL POINT

AREA TO BE USED FOR THE DISPLAY OF ALCOHOL; PRODUCTS PACKED WITH ALCOHOL AND NON-ALCOHOL DRINKS

PROJECT:
5419
MAIN STREET PRESTWICK EXP

DESCRIPTION
PROPOSED ALCOHOL LICENCE RETAIL LAYOUT

DRAWING NO. 5419gag2#BWSPLAN.dwg

PHASE **3** ISSUE **2#**

SYSTEM ID. No. 5419bg2#BWSPLAN.dwg, 5419rg2#BWSPLAN.dwg

SCALE **1:100@A3** DATE **17.12.2018**

UK PLANNING MANAGER **STEVEN ANDRZEJUK**

TESCO
RETAIL PLANNING AND DESIGN IMPLEMENTATION

TESCO STORES LIMITED
EXPRESS GROUP
HIGHWOOD BUILDING, KESTREL WAY, HERTFORDSHIRE
WELWYN GARDEN CITY, HERTFORDSHIRE, ALY 1GB UK
TELEPHONE: 01707 300150

THE COMPANIES IN THE TESCO GROUP ARE REGISTERED IN ENGLAND AND WALES. THE COMPANIES ARE REGISTERED AT 200, BRISTOL ROAD, BIRMINGHAM, B2 4BW. ALL RIGHTS RESERVED. THIS DRAWING IS THE PROPERTY OF TESCO STORES LIMITED. IT IS TO BE USED ONLY FOR THE PURPOSES SPECIFIED AND IS NOT TO BE REPRODUCED OR TRANSMITTED IN ANY FORM OR BY ANY MEANS, ELECTRONIC OR MECHANICAL, INCLUDING PHOTOCOPYING, RECORDING, OR BY ANY INFORMATION STORAGE AND RETRIEVAL SYSTEM, WITHOUT THE EXPRESS WRITTEN PERMISSION OF TESCO STORES LIMITED.