

62 PIEDMONT ROAD, GIRVAN.

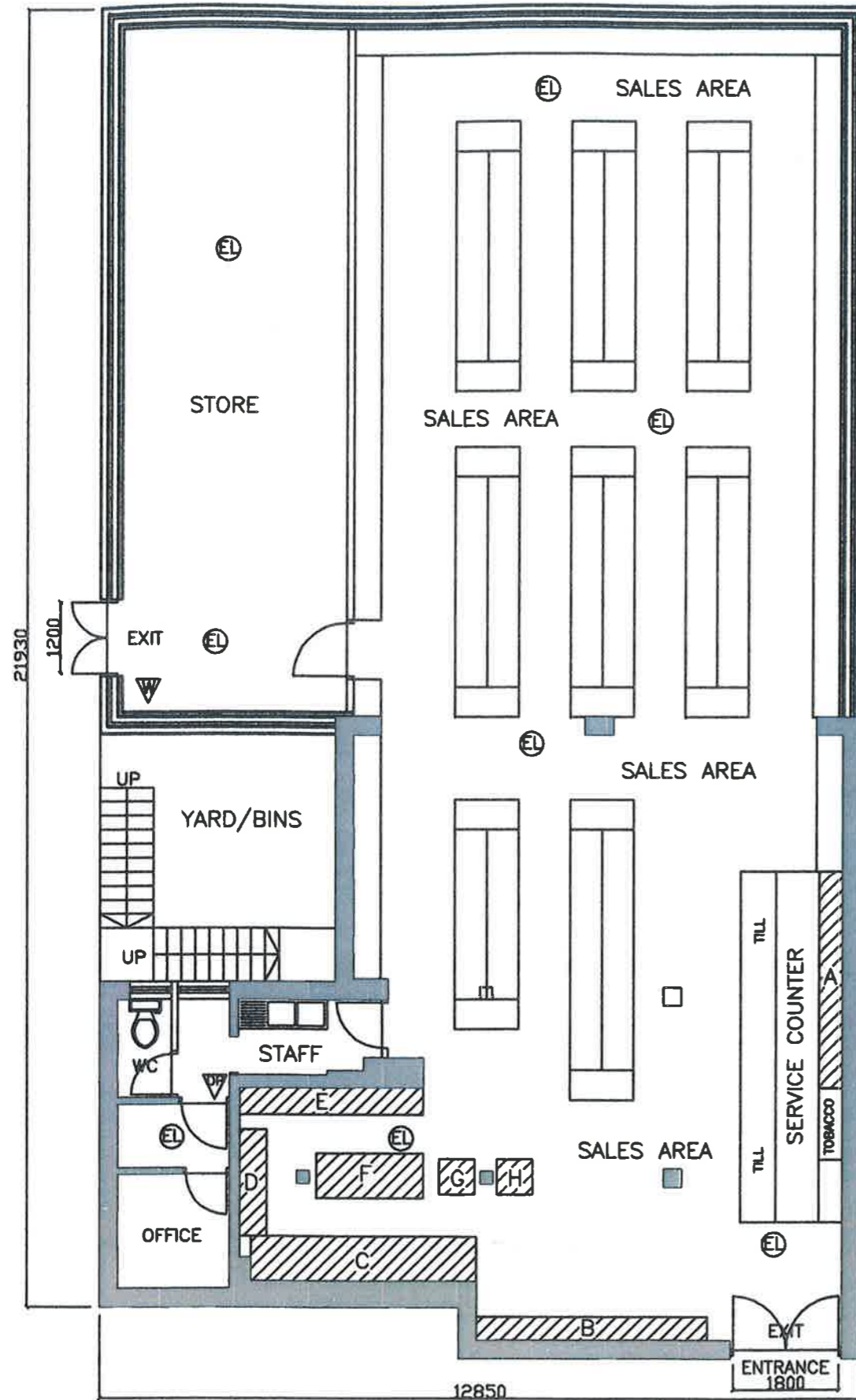

DRINKS DISPLAY LEGEND

- A 3650mm wide
400mm deep
2150mm high
- B 3900mm wide
400mm deep
2150mm high
- C 3800mm wide
750mm deep
2000mm high
- D 1800mm wide
450mm deep
2000mm high
- E 3100mm wide
450mm deep
2000mm high
- F 1800mm wide
750mm deep
1000mm high
- G 600mm wide
600mm deep
1000mm high
- H 600mm wide
600mm deep
1000mm high

FIRE FIGHTING / PREVENTION KEY

- GENERAL FIRE ACTION NOTICE N1
- STAFF FIRE ACTION NOTICE N2
- KEEP LOCKED SHUT NOTICE N3
- EMERGENCY LIGHTING EL
- ILLUMINATED EXIT SIGN IES
- SMOKE DETECTOR SD
- HEAT DETECTOR HD
- DRY POWDER EXTINGUISHER ▽
- WATER EXTINGUISHER ▽
- FIRE BLANKET FB
- FIRE ALARM CALL POINT ●
- FIRE ALARM SOUNDER ⌒
- ILLUMINATED EXIT SIGN IES

This is the Layout Plan referred to in the application by Mr Arif Ali Malik for Variation of the Premises Licence for Sallys Minimarket, 62 Piedmont Road, Girvan, KA26 ODS

P I E D M O N T R O A D