

HOLLOW PARK STORES  
2 HOLLOW PARK, AYR.

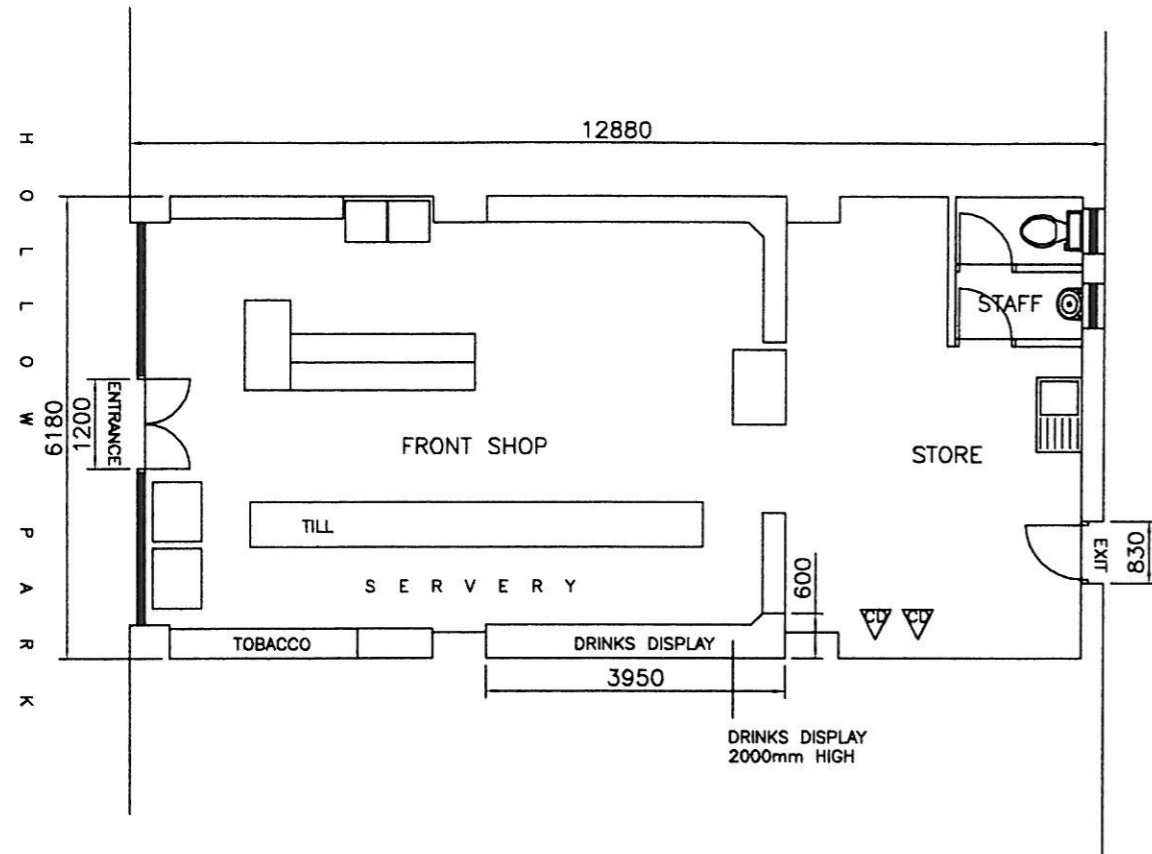

EXISTING GROUND FLOOR PLAN 1/100

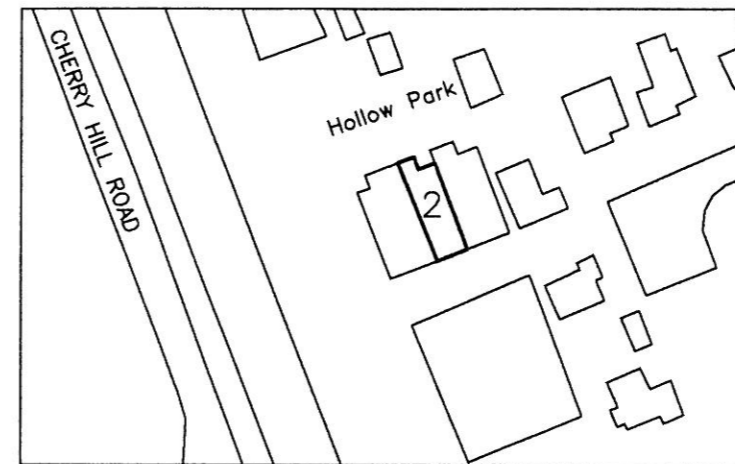

LOCATION PLAN

LEGEND

- GENERAL FIRE ACTION NOTICE N1
- STAFF FIRE ACTION N2
- KEEP LOCKED SHUT NOTICE N3
- EMERGENCY LIGHTING EL
- SMOKE DETECTOR SD
- HEAT DETECTOR HD
- DRY POWDER EXTINGUISHER ▽
- FOAM EXTINGUISHER ▽
- WATER EXTINGUISHER ▽
- FIRE BLANKET FB
- FIRE ALARM CALL POINT ●
- FIRE ALARM SOUNDER ⤴
- ILLUMINATE EXIT SIGN IES
- CARBON DIOXIDE EXTINGUISHER ▽
- CHILDRENS AREA ▨
- GAMING MACHINE GM

PROJECT  
HOLLOW PARK STORES

TITLE  
EXISTING FLOOR PLAN  
& LOCATION PLAN

**J. REID & SONS**  
ARCHITECTURAL SERVICES

197 MAIN ST  
PRESTWICK  
KA9 1LH  
Tel.: 01292 470331



SCALE  
1:100

DATE	JOB NO.	DRG NO.	REV
25/02/08			

Drawn by JAMES REID	Passed by	Issued for
------------------------	-----------	------------