

# Heads of Ayr Holiday Park, Dunure Road, Ayr.

BASED UPON THE  
ORDNANCE SURVEY MAP  
WITH THE SANCTION OF THE  
CONTROLLER OF H.M.  
STATIONARY OFFICE. CROWN  
COPYRIGHT RESERVED  
OS LICENCE No. LIG 1357

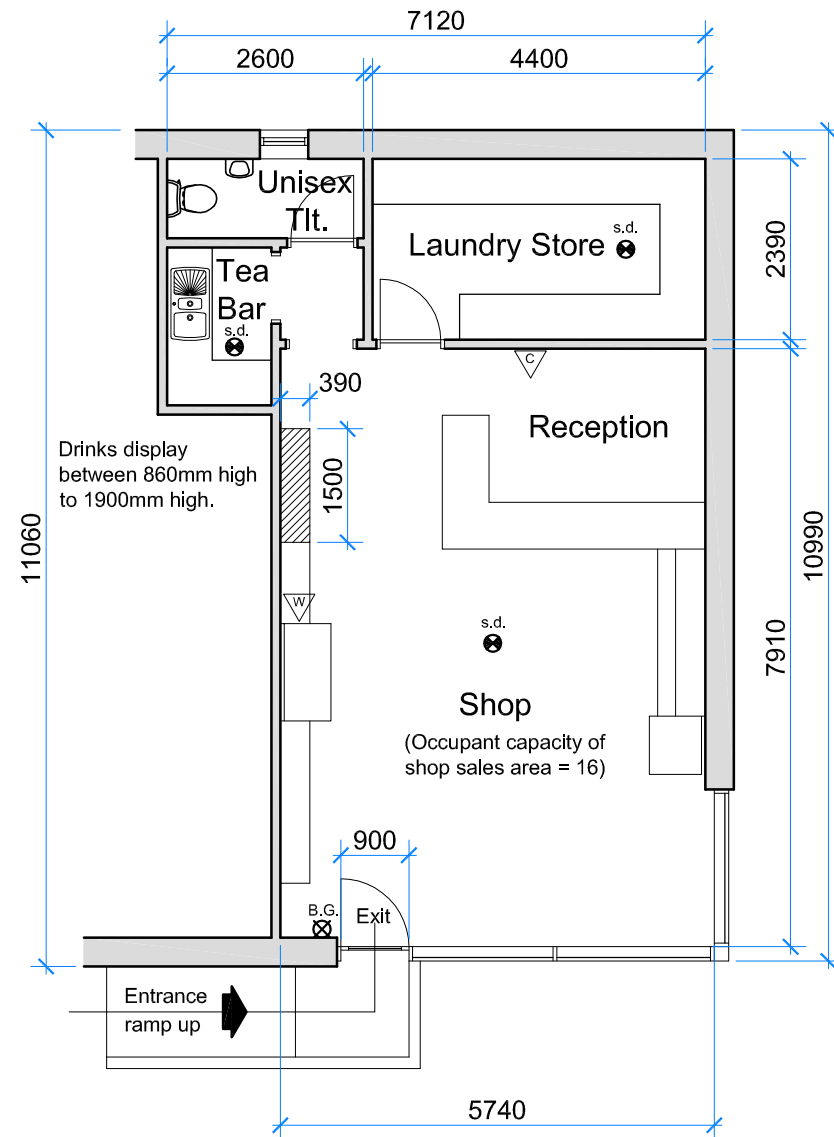

**Ground Floor Plan**  
(Scale: 1/100)

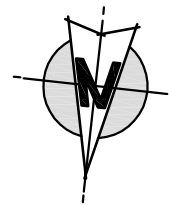
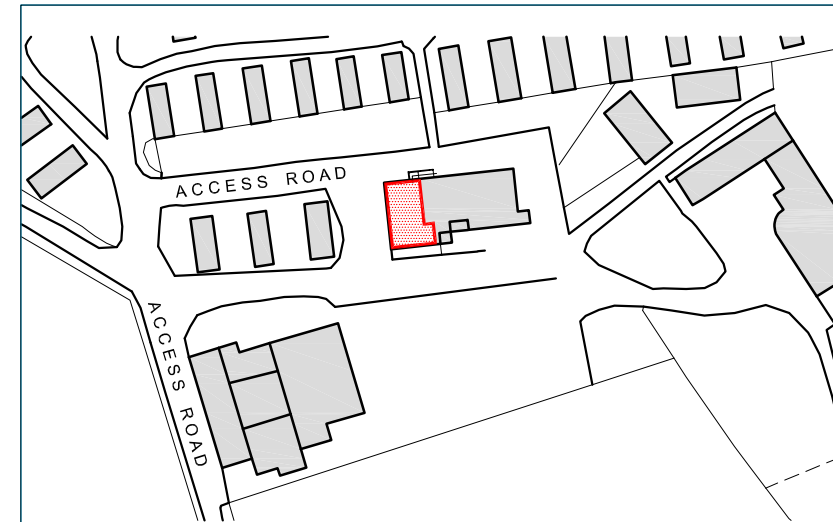
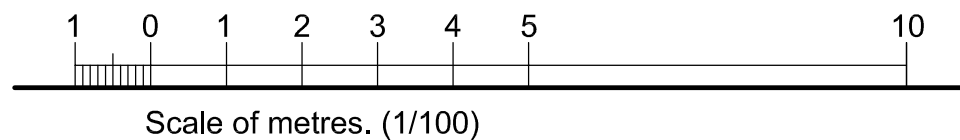

**Location Plan**  
(Scale: 1/1250)

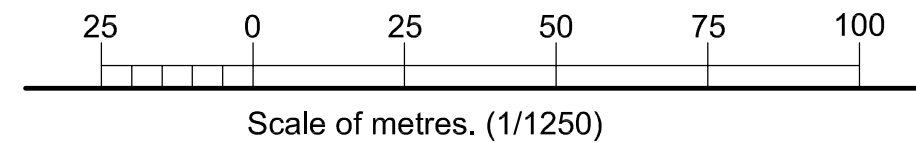

### Legend

- Carbon dioxide extinguisher.
- Water extinguisher.
- Drinks display area.
- Smoke detector.
- Break glass point.

client <b>Mr. Graham Brown</b>	drawing <b>Floor Plan &amp; Location Plan. (License plan.)</b>	DRG.No. 22.622:LP01 <sup>REV</sup>		
project Heads of Ayr Holiday Park Dunure Road, Ayr.	e-mail : t.l.sweeney@btinternet.com 55 Rowan Crescent Tel : 01292 280250 Ayr KA7 3NA Mob : 07500 808130	scale <b>1:100</b>	date <b>June 22</b>	drn. by <b>T.L.S.</b>
		<b>Tom Sweeney</b> Architectural Services Chartered Architectural Technologist		